



SCALE: 1" = 10'

NO	DATE	REVISION
1	06/30/2023	GRAD PERMIT REVIS
2	08/15/2023	GRAD PERMIT REVIS
3	10/10/2023	GRAD PERMIT REVIS
4	12/22/2023	BLDG PERMIT REVIS
5	04/11/2024	BLDG, WTR, ENV PERMIT REVIS

©2023 Sherwood Design Engineers
The design and drawings shown are the sole property of Sherwood Design Engineers and may not be used without the prior written consent of Sherwood Design Engineers.

PROJECT NO. 20-174

DATE	05/19/2023
DRAWN	VHT
DESIGNED	CN
CHECKED	CANMH

BUILDING PERMIT

OAK KNOLL RESORT LLC
KNOLL HOUSE
5091 SOLANO AVENUE
NAPA, CA

UTILITY PLAN - NORTHWEST

DRAWING NO.
C4.4
15 OF 26

UTILITY LEGEND

	(E) ELECTRIC TRENCH, SEP
	(E) UTILITY POLE
	(E) GAS TRENCH
	(P) GAS TRENCH, SPP
	(P) SEWER FORCE MAIN
	(P) GREASE WASTEWATER LINE PER NOTE 4/C4.0
	(P) SEWER PIPE PER NOTE 4/C4.0
	(P) JOINT TRENCH
	(E) WATER PIPE (CONFIRM SIZE)
	(P) WATER PIPE
	(P) NON-POTABLE WATER PIPE
	(P) 10" NON-POTABLE FIRE HYDRANT PIPE
	(P) 6" NON-POTABLE FIRE SPRINKLER MAIN LINE
	(P) 2" NON-POTABLE IRRIGATION PIPE
	(P) STORM DRAIN PIPE PER NOTE 5/C4.0
	(P) UNDER DRAIN PIPE PER NOTE 5/C4.0
	(P) PERIMETER DRAIN PER G/C7.2
	(P) AREA DRAIN PER A/C7.2
	(P) DRAIN INLET JUNCTION BOX PER C7.3. JB-UD INCLUDE 12" MIN BOTTOM SUMP
	(P) TRENCH DRAIN PER E/C7.4
	(P) SLOT DRAIN PER F/C7.4
	(P) SD CLEAN OUT PER D/C7.2
	(P) DOWNSPOUT CONNECTION PER E/C7.2
	(P) ROCK INLET/OUTLET PROTECTION PER A/C7.3 OR B/C7.3
	(P) THRUST BLOCK PER D/C7.5
	(P) UTILITY POC, SPP
	(P) FIRE DEPARTMENT CONNECTION (SEE NOTE 6/C4.0)
	(P) FIRE HYDRANT PER B/C7.5
	(P) SEWER CLEANOUT (SEE NOTE 4/C4.0)
	(P) SS LIFT STATION, (SEE NOTE 4/C4.0)
	(P) SS GRAVITY MAINTENANCE HOLE (SEE NOTE 4/C4.0)

- KEYNOTES**
- 50,000 GALLON NPW STORAGE TANK FOR FIRE PROTECTION AND IRRIGATION STORAGE PER A/C7.6
 - POWER POLE, SEP
 - FLOAT CONTROL VALVE TO FILL WATER STORAGE TANK, ONE VALVE PER WATER SUPPLY LINE PER F/C7.5
 - AIR GAP MANHOLE, SEE DETAIL E/C7.5
 - WASTEWATER TREATMENT TANK, SWWP
 - 40,000 GALLON DOMESTIC WATER STORAGE TANK PER B/C7.6
 - FIRE PUMP VAULT PER A/C7.6
 - SWWP FOR EQUIPMENT LAYOUT, DETAILS, PIPE SIZES AND INVERTS
 - NPW SUBSURFACE INFILTRATION LEACHFIELD, SWWP
 - FINAL DRAINAGE LOCATION TO BE VERIFIED BY THE LANDSCAPE ARCHITECT
 - CONNECT UD TO SD AT SDCO PER C/C7.2
 - OUTLET TD TO SWALE
 - SOLAR INVERTER BY OTHERS
 - REDUCE PRESSURE BACKFLOW PREVENTER PER THE CITY OF NAPA STANDARD DETAIL W-6A. OWNER SHALL TEST THE BACKFLOW DEVICE ONCE A YEAR FOR THE LIFE OF THE WATER SERVICE OR AS REQUIRED PER CITY AND STATE REGULATIONS
 - INSTALL WALL SUBDRAIN PER GEOTECHNICAL ENGINEER'S SPECIFICATIONS
 - CONNECT TO (E) WATER SERVICE METER PER CITY OF NAPA STANDARDS W-1. REPLACE METER WITH AN ULTRASONIC METER SUPPLY BY THE CITY OF NAPA AT THE OWNER'S EXPENSE
 - REFER TO POOL CONSULTANT PLANS FOR UTILITIES IN THIS AREA
 - PROVIDE BOLLARD PROTECTION PER A/C7.5 AND THE FIRE DEPARTMENT ACCESS AND PROTECTION REQUIREMENTS
 - ALL MONUMENTS SHALL BE PROTECTED PER THE MONUMENT NOTE 1 ON SHEET C0.1
 - FOUNDATION UNDERDRAINS SHALL BE INSTALLED PER THE GEOTECHNICAL ENGINEERS RECOMMENDATION. CONNECT TO SD WHERE SHOWN. ALL SUBDRAINS SHALL BE CONVEYED SEPARATELY FROM THE DRAINAGE NETWORK.
 - 4" SDR 35 PVC AIR VENT LINE TO BE VENTED THROUGH THE BUILDING PER PLUMBING ENGINEER'S REQUIREMENTS
 - LEVEL SENSOR FOR FLOAT CONTROL VALVE PER DETAIL C/C7.6
 - STUB UP TWO (2) 2" DW LINES WITHIN UTILITY BOX FOR FUTURE CONNECTION. UTILITY BOX SHALL BE INSTALLED PER F/C7.5
 - 25 FT MIN SEPARATION BETWEEN UNDER DRAINS AND SEWER LINES, REFER TO THE WW PLANS FOR UTILITY SETBACKS
 - NSF DOMESTIC WATER PUMP VAULT PER B/C7.6
 - UTILITY CROSSING PER DETAIL C/C7.4 AND CITY OF NAPA WATER LINE CROSSING PER STD DETAIL 22B

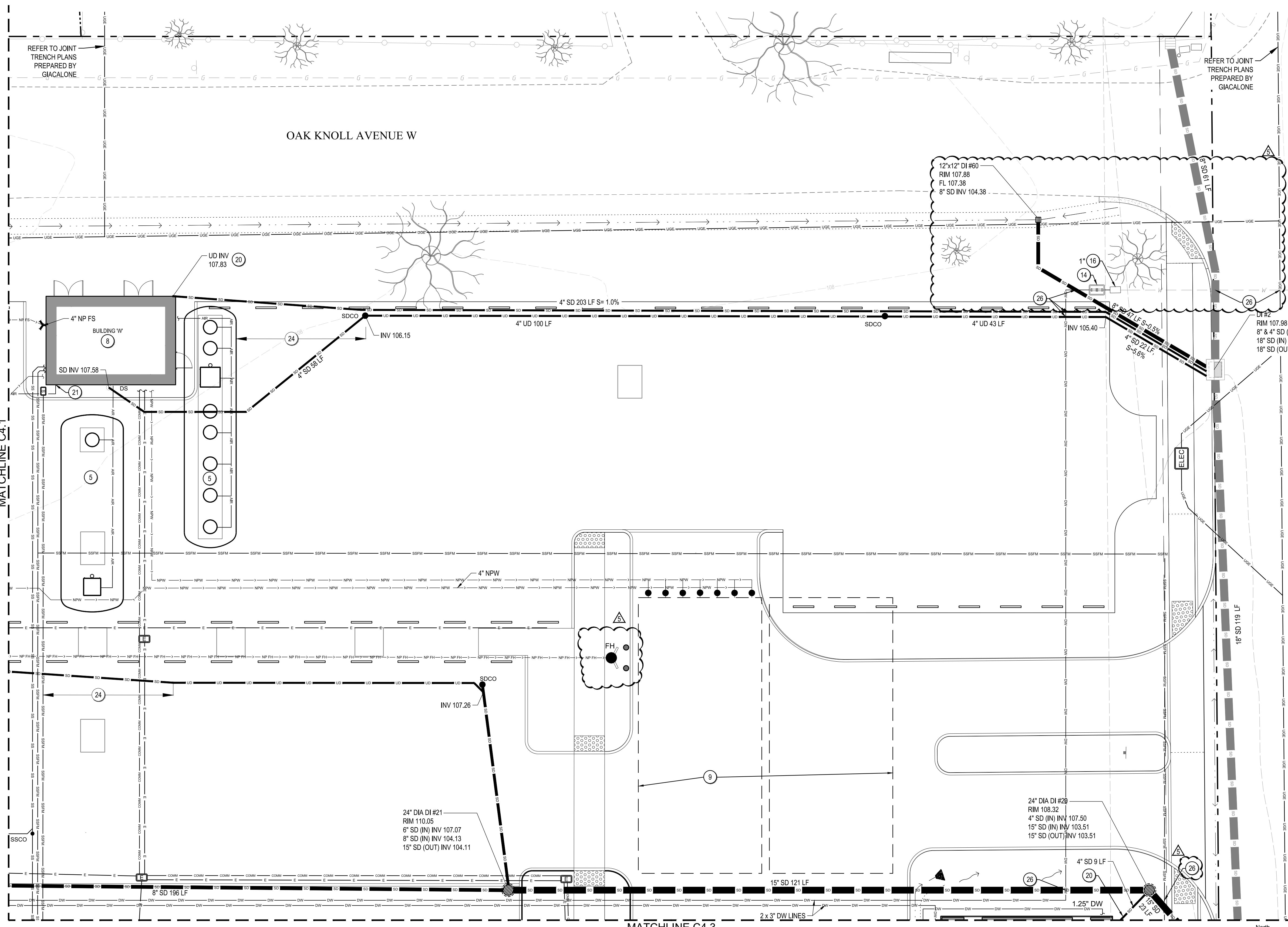

UTILITY PLAN - NORTHWEST
SCALE: 1" = 10'