

## EXHIBIT A

### DESCRIPTION:

The land referred to herein is situated in the State of California, County of Napa, City of Napa, and is described as follows:

COMMENCING AT THE POINT OF INTERSECTION OF THE SOUTHERLY LINE OF VALLEJO STREET WITH THE EASTERLY LINE OF BROWN STREET; RUNNING THENCE EASTERLY, ALONG SAID SOUTHERLY LINE OF VALLEJO STREET, 60 FEET; THENCE AT RIGHT ANGLES SOUTHERLY, AND PARALLEL WITH BROWN STREET 120 FEET; THENCE AT RIGHT ANGLES WESTERLY, AND PARALLEL WITH VALLEJO STREET, 60 FEET TO THE EASTERLY LINE OF BROWN STREET; THENCE AT RIGHT ANGLES NORTHERLY, ALONG SAID EASTERLY LINE OF BROWN STREET, 120 FEET TO THE POINT OF COMMENCEMENT.

APN: 003-104-001

EXHIBIT A

3-10

"I hereby certify that the information contained herein is true and correct to the best of my knowledge and belief, and that I am not aware of any facts or circumstances which might materially affect its accuracy."

2014  
2012

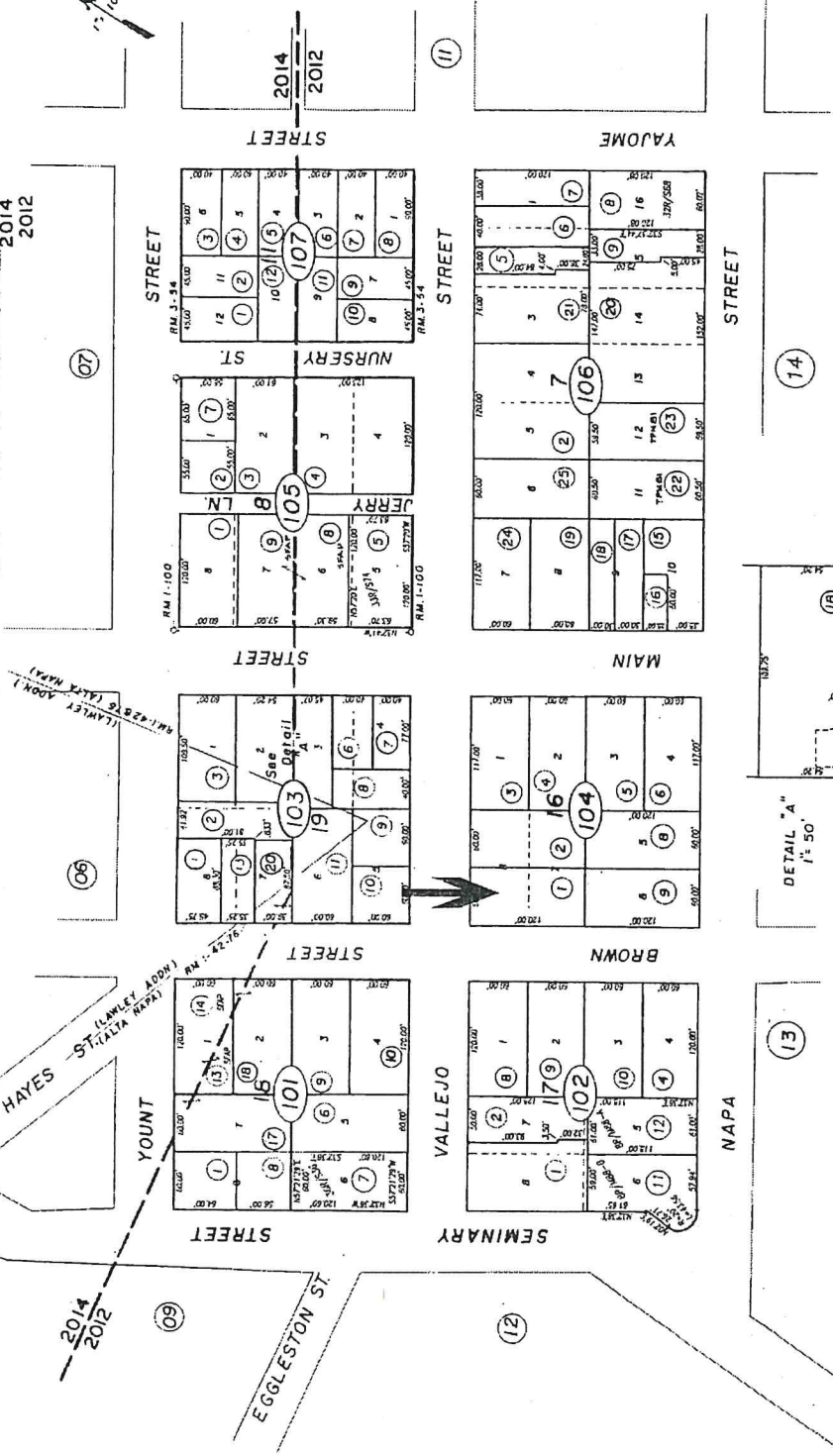
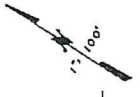

CITY OF NAPA  
Assessor's Map Bk. 3 -Pg.10  
County of Napa, Calif.  
1953-58-59

REVISION	DATE
105-08-85	6-13-84
106-08-85	9-22-84
107-08-85	3-20-85
108-08-85	6-21-84

Lawley Addn. RM. Bk. Pg.  
Mounts Subd. RM. Bk.1, Pg.100  
Knox Subd. RM. Bk.3, Pg.54  
Alta Napa RM. Bk.1, Pgs.42 & 76

NOTE: This Map Was Prepared For  
Assessment Purposes Only - No  
Liability is Assumed For The  
Accuracy Of The Data Delineated  
Hereon.